



The Town of Flatrock

663 Wind Gap Road
Flatrock, NL
A1K 1C7

PHONE (709) 437-6312
FAX: (709) 437-6311

ACCESSORY BUILDING APPLICATION

Applicant: _____ Phone: _____
Email Address: _____ Alternate Phone: _____
Mailing Address: _____
Address of property: _____
Contractor: _____ Phone: _____

Type of Permit/Permission

Build Residential: _____ Build Shed: _____ Commercial Building: _____
Build Extension: _____ Build Garage: _____ Industrial Building: _____
Residential Subdivision: _____ Specify number of proposed lots: _____ Demolition: _____
Development Location: _____ Construction Value: _____
(Estimated)

Description of Land to Be Developed

Frontage: _____ (m/ft) Depth: _____ (m/ft) Area: _____ (m/ha or ft/acre) _____ As per Survey: _____

Existing land uses (check appropriate one & Specify):

Residential: _____ Crown Land: _____ Unknown: _____
Commercial: _____ Vacant: _____ Other: _____

Describe Intended Use

If Residential:

Single Family Dwelling: _____ Single Family Dwelling c/w Apartment: _____
Extension to Dwelling: _____ Accessory Building (shed/garages): _____ Other: _____
(specify)

If Commercial:

Retail: _____ Industrial: _____ Extension to Building: _____ Other: _____
Office: _____ Restaurant: _____ New Tenant Up Fit: _____ (specify)

Describe Building (if applicable)

Dimension: _____ (m/ft) Area: _____ (m/ft) Height: _____ (m/ft) Setback: _____ (m/ft)
Heating Type: _____ # Washrooms: _____ Attached garage: Y / N
Propane/Oil Appliances: _____

Proposed Means of Access:

Existing Access: _____ New Access (culvert): _____ New Access (subdivision) _____

ACCESSORY BUILDINGS

a) An accessory building on a lot which has a single family dwelling shall have a lot coverage up to a maximum of 85m² for under 3035 meters and maximum of 110m² for 3035 meters or more for all buildings and still a maximum of 85m² for one building, and a height of no more than 4.5 metres: that a two-story accessory building could be constructed at a maximum height of 6.10 metres, with the first floor area of a maximum of 50 m², and the first floor to the ceiling being a maximum height of 2.64 metres (9');

b) No accessory building shall project in the front of any building line setback.

c) Accessory buildings, in any zone, when abutting a residential property or residential zone, shall not be located closer than 1.5 meters from the abutting residential property or zone.

d) A survey of the land must be included with your application.

ACCESSORY BUILDINGS
AND
DETACHED GARAGES

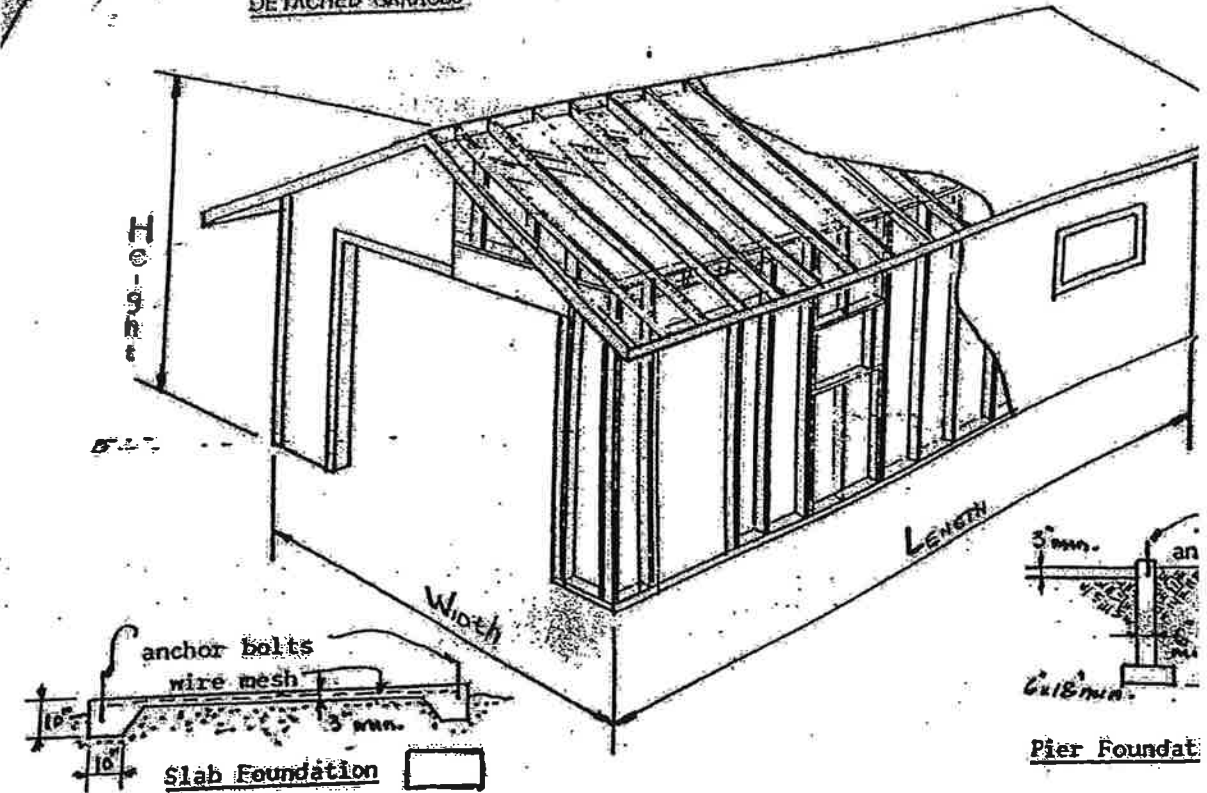

WIDTH _____
 LENGTH _____
 HEIGHT _____
 SIDE-YARD, LEFT _____
 SIDE-YARD, RIGHT _____
 DIST. FROM REAR YARD _____
 DIST. FROM HOUSE _____
 EASEMENT SIDE _____
 EASEMENT REAR _____

CONSTRUCTION

RAFTERS - 2" x _____ " centres
 STUDDING - 2" x _____ " centres
 ROOF - sheathing
 ROOFING Shingles _____
 Roll _____
 CAR DOOR _____ x _____
 SIDE DOOR _____
 WINDOWS NO. front _____ R. Side _____
 L. Side _____ Rear _____
 EXTERIOR FINISH _____

Date _____
 Name _____

I (We), _____, the Applicant(s) named herein, do solemnly declare the statements herein contained in this application are true and made with a full knowledge of the circumstances development described in the said application. I (We) make this solemn declaration, conscientiously believing it to be true and with the full knowledge of the property owner, and knowing that it is of the same force and effect as if made under oath

Signature: _____ Date: _____

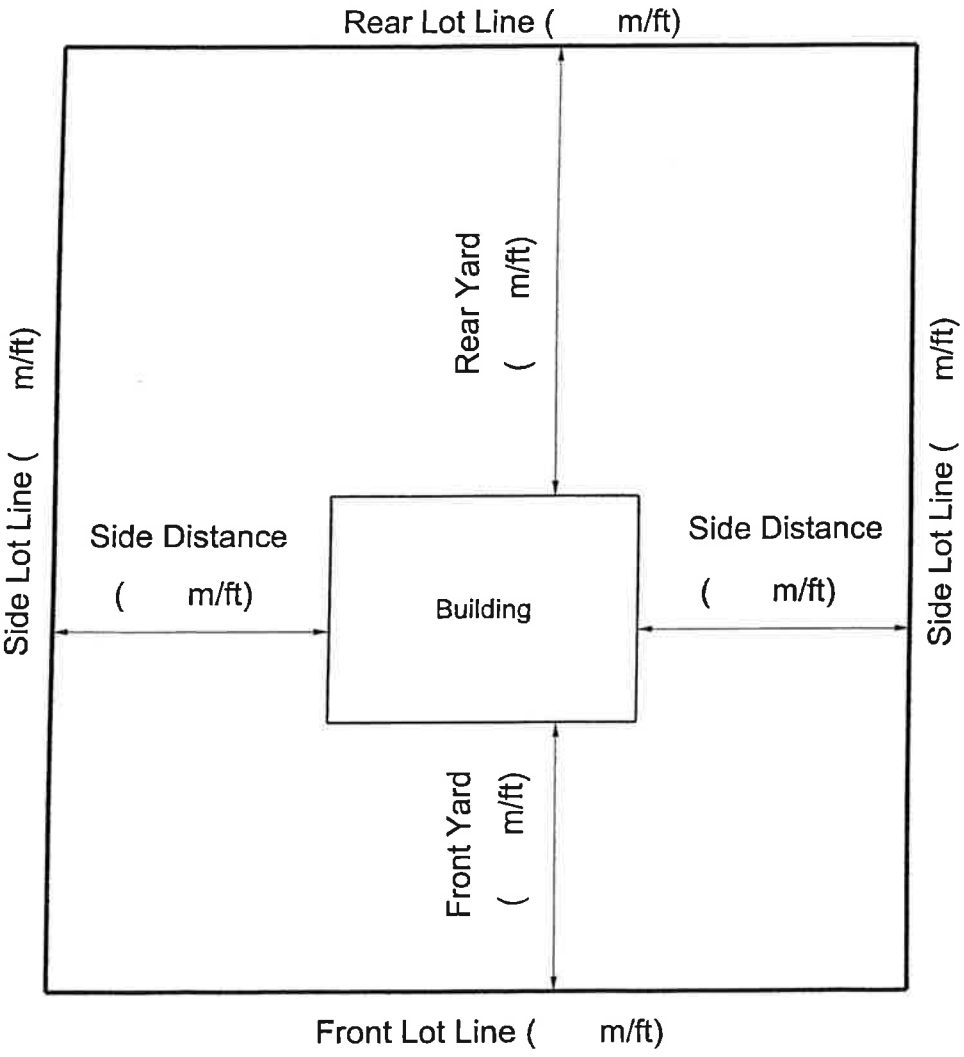

Describe Renovation, Repair, Extension, Etc. (additional information)
